

REVISIONS				
ECN	REV.	DESCRIPTION	DATE	APPROVED
	A	RELEASE FOR PRODUCTION	12-03-09	
	B	ADD UNC 8-32 4PL FOR FEET	08-13-12	
13014	C	CHANGE HOLE PATTERN TO DRV.8.003.1	08-13-12	
	D	CHANGE HOLE PATTERN TO DRV.8.003.1	05-12-13	
20017	E	UPDATE DRAWING, WOOFER CUTOUT, PORT DIAMETER	03-30-20	

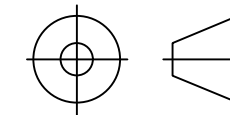
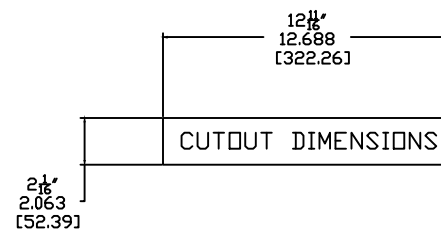
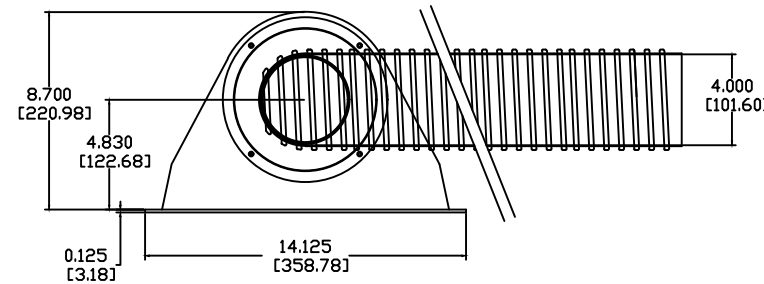
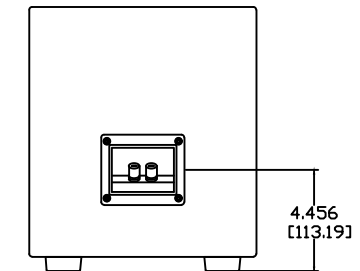
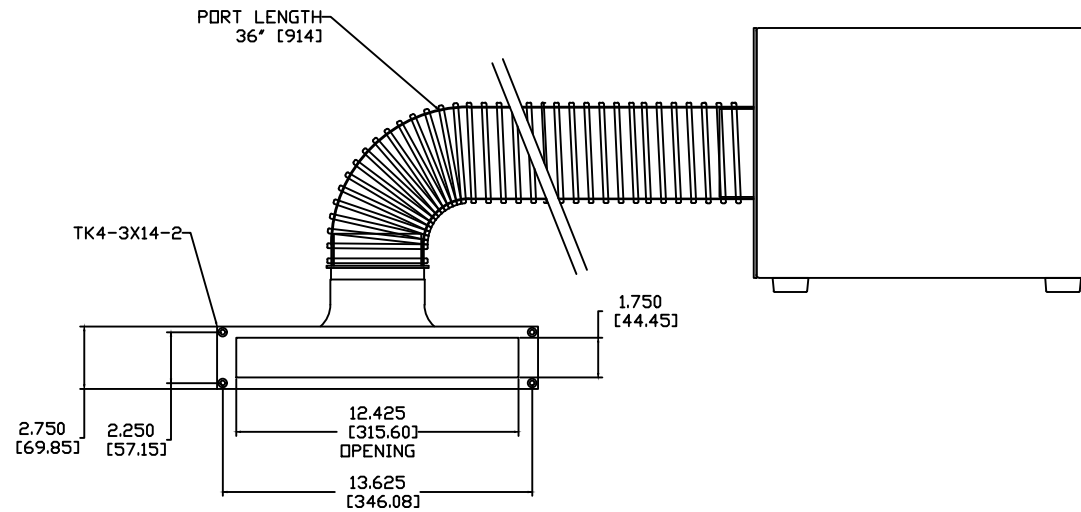
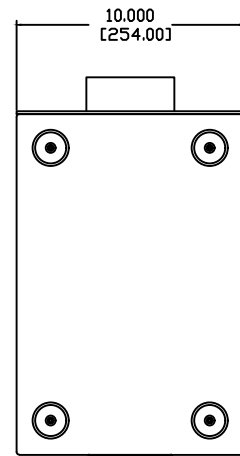
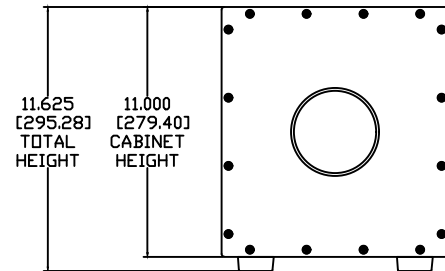
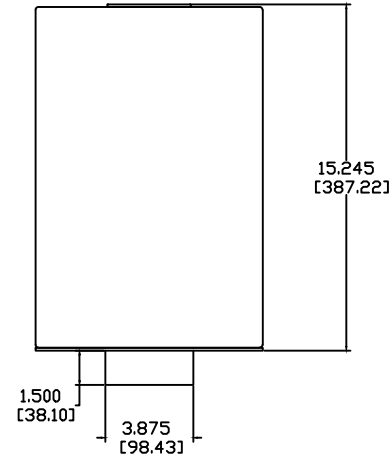

"THIRD ANGLE" PROJECTION

NOTES:

- 1: MATERIAL - 5052 ALUMINUM  
UNLESS OTHERWISE SPECIFIED
- 2: FINISH - STUDIO BLACK POWDER COAT  
UNLESS OTHERWISE SPECIFIED
- 3: PORT LENGTH - 4" DIA. @ 36" LONG
- 4: IMPEDANCE - 8 OHMS

PROPRIETARY INFORMATION  
THE DESIGNS, INFORMATION, AND DATA CONTAINED HEREIN ARE PROPRIETARY AND ARE SUBMITTED IN CONFIDENCE, AND SHALL NOT BE DISCLOSED, USED OR DUPLICATED IN WHOLE OR IN PART, FOR ANY PURPOSES WHATSOEVER, WITHOUT THE PRIOR WRITTEN PERMISSION OF JAMES LOUDSPEAKER LLC, 2185 PARK PL, MINDEN, NV 89423. THIS LEGEND SHALL BE MARKED ON ANY REPRODUCTIONS HEREOF IN WHOLE OR IN PART. RECEIPT OF THIS DOCUMENT SHALL BE DEEMED TO BE AN ACCEPTANCE OF THE CONDITIONS SPECIFIED HEREIN.

JAMES LOUDSPEAKER

800PTM

EXTERNAL DIMENSIONS

P/N: - DWR #: 091203-A00

REVISED BY: S. LOESCH

DRAWN BY: M. PARK FILE:

DATE: 12-03-20 SCALE:

APPROVED:

DRAFTING APPROVED:

DO NOT SCALE DRAWING

DRAWING NOT TO BE USED FOR CNC

TOLERANCES: ANG: ± = .5° FRACT. ± = 1/32  
DECIMALS: .XX ± = .01 .XXX ± = .005

REVISION: E

SHEET 1 OF 4